

Upgrade Existing Security Systems With Videofied.

Expedited Dispatch It is all about faster police response. Videofied systems deliver ten-second video clips to central stations with the alarm- and police respond to a crime-in-progress.

Videofied alarms mean:

Faster Response Greater Security Greater Value



Upgrade Existing Systems

VIA-VU attaches to existing alarm panels using the panel's alarm output to auto-arm the VU when the existing panel goes into alarm. As far as the homeowner is concerned, nothing changes – not the keypad, not the user interface. The operation of the existing panel is not degraded and it continues to function normally. When the existing panel goes into alarm this also arms the VU. Any movement triggers the P-CAM motion sensors which immediately activate the camera, capturing an MPEG video. This means that cameras are never armed or activated unless there is an alarm – privacy is assured.

Concept Patented wireless P-CAMs (integrated PIR motion sensor and camera) capture 10 seconds of video documenting WHAT triggered the alarm. This MPEG is sent to the monitoring station with the Contact ID alarm so that personnel immediately know WHY there is an alarm. Videofied means an intrusion is no longer just an alarm; it is a crime in progress. Law Enforcement wants to catch criminals. Security companies desire efficient response. Videofied enables both.

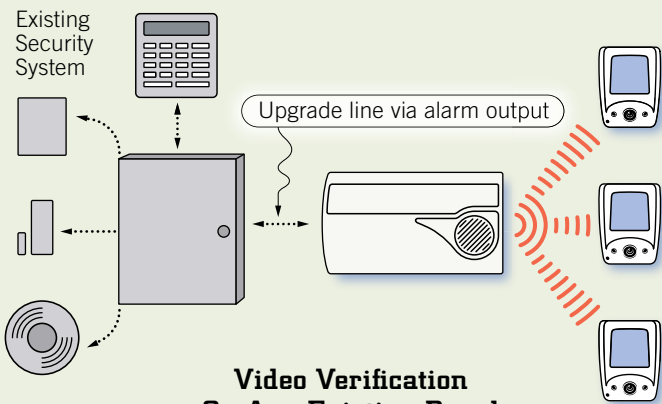

Video Verification On Any Existing Panel

- Boost RMR from existing customers** – raise rates with video verification.
- 30 minute install** – no wires, no hassle.
- Easiest sell-ever!** They have already bought from you and trust you.
- Expedited law-enforcement** – especially in non or slow-response jurisdictions.
- EVERY house is prospect** – this product can be used with millions of installed systems.
- Greater retention** – customer value every day with email video delivery.



Communications VIA-VU may be used with either primary or secondary line seizure – depending on whether the installation is in a non-dispatch jurisdiction or not. In areas requiring verified alarms we recommend that the VU be given primary line seizure for expedited response. In either

case, when there is no video the existing panel functions as before. When video is captured it is delivered to the Central Station for improved security.

Simple and efficient Central Station Integration Seamless workstation integration with one-touch viewing by operator. No DVR management. Most importantly, there is “no peeking.” The camera is active ONLY during an alarm protecting privacy.



Proven Over 60,000 systems installed worldwide give RSIalarm's Videofied solution the largest installed base of any video verification system or technology.



Feature

- 2-way wireless between all P-CAMs and VU unit.
- 4 year battery power with no AC power connections in VU system.
- Integrates seamlessly into existing Monitoring solutions.

Electrical Data

RF technology	S ² VIEW	Night illumination	2 infrared LEDs
Radio type	Bidirectional	Night illumination distance	14 ft./2.5 ft.
Operating frequency	915 MHz	Motion detector technology	Passive infrared
Transmission type	Spread spectrum	Motion detector type	Dual elements
Transmission security	AES algorithm encryption	Motion lens	Fresnel
Video format	MPEG	Motion detection	90°
Size	200 Kbytes	Motion detection distance	40 ft. / 12 m
Video framing	5 frames/second		
Picture format	JPEG		
Picture size	320 x 240 pixels		
Operating temperature	32° - 104° F (0° - 40°)		
Maximum relative humidity	70%, non-condensing		
UL listing	1023 (pending)		



202 East Golden Lake Circle
Minneapolis, Minnesota 55014
USA

877-206-5800
www.videofied.com